

Typical Details

Rockwood Classic™

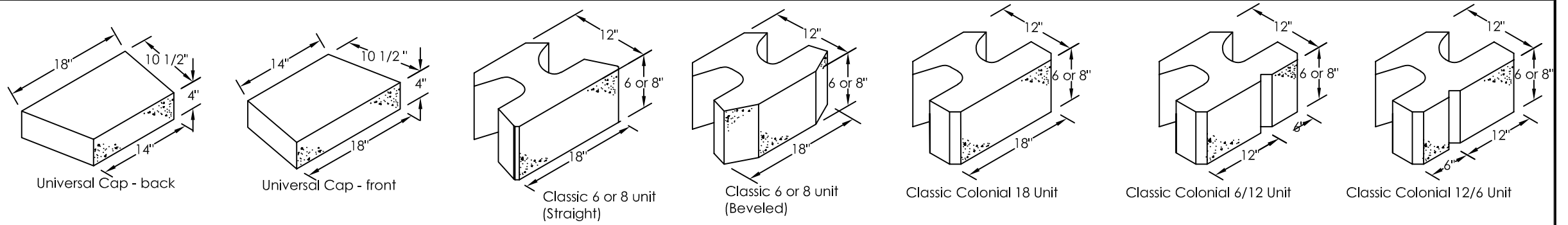

| NCMA Minimum Embedment | |
|------------------------|--|
| Slope in front of wall | Minimum H_{emb} to top of leveling pad |
| Horizontal (Walls) | H'/20 |
| Horizontal (Abutments) | H'/10 |
| 3H:1V | H'/10 |
| 2H:1V | H'/7 |
| Minimum embedment | 6 in |

Note: H' is the exposed height of the SRW. The bottom of the wall should not be above the finish grade elevation 4ft in front of the wall

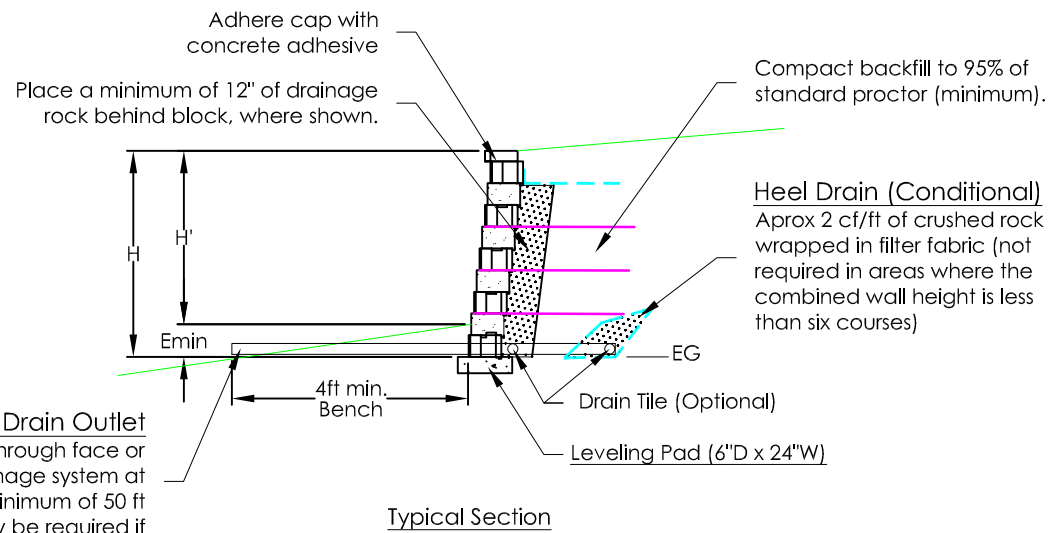

Heel Drain Outlet
Stub-out 4" drain pipe from heel drain through face or end of wall, to "daylight" or area drainage system at the lowest practical elevation at a minimum of 50 ft intervals. More than one outlet may be required if multiple low points exist along the length of the wall.

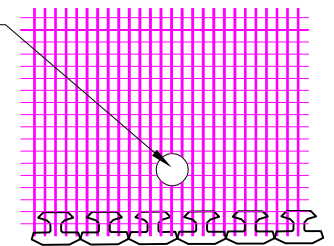
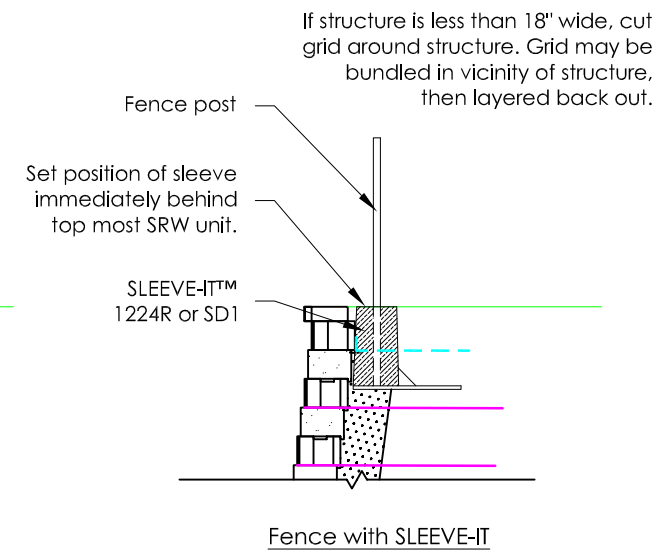
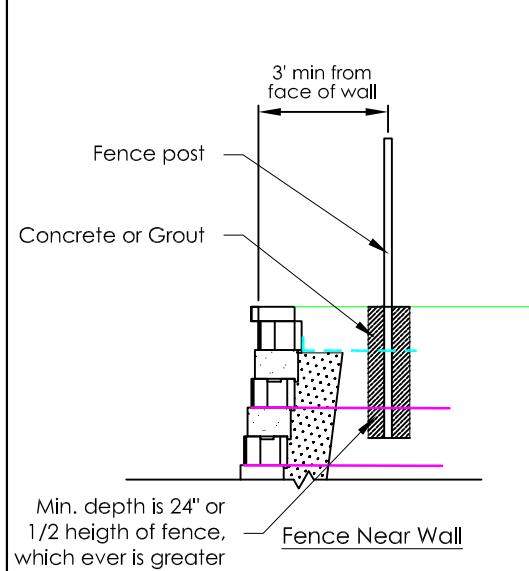

Plan View
Note: Cut successive layers of Geogrid around proposed fence post or guardrail post installation points. Backfill and compact around Sonotube or SLEEVE-IT. Check fence design for embedment depth of fence post.

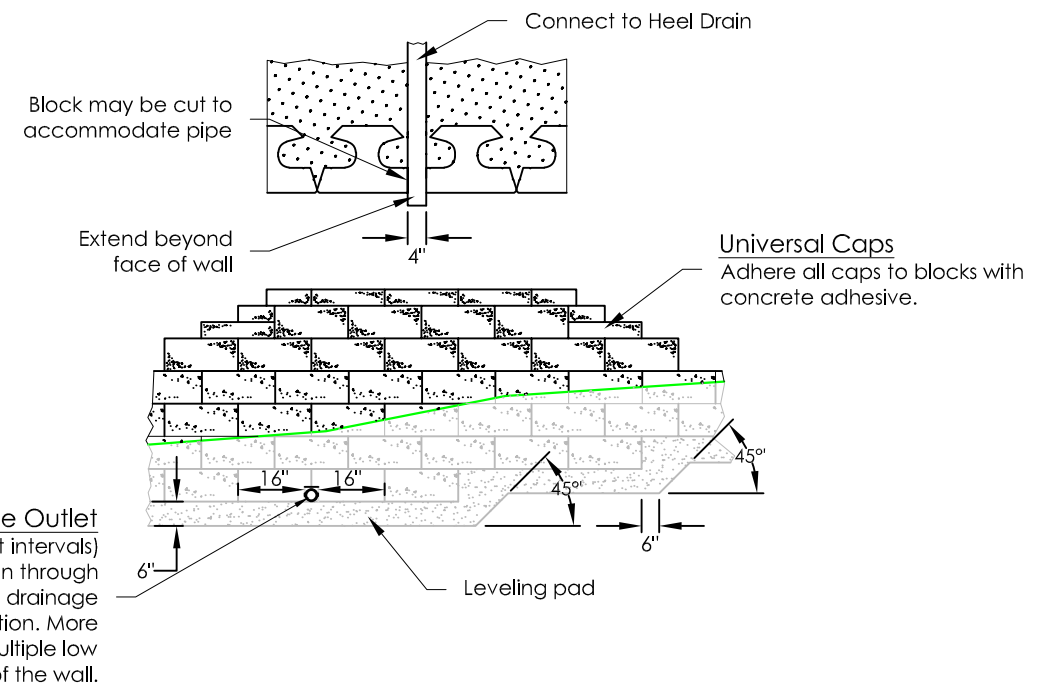
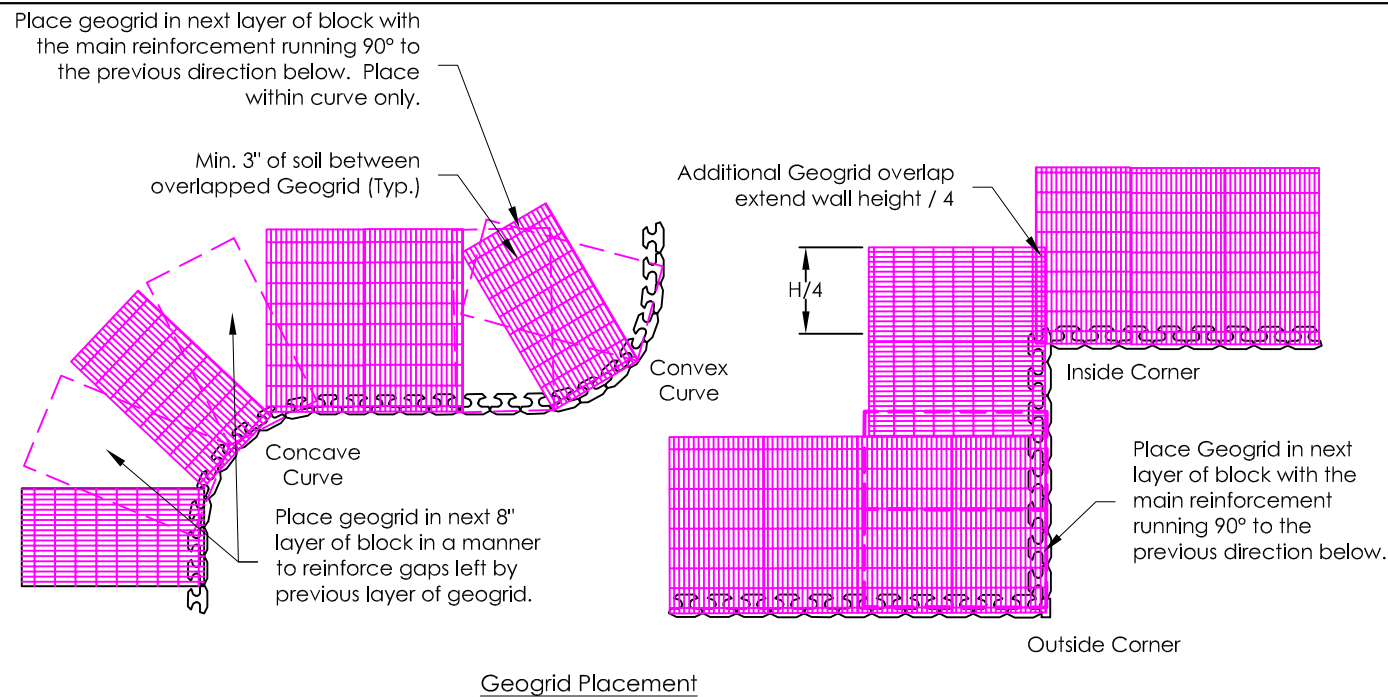

This drawing is furnished for preliminary design purposes only, and should not be used for final design drawings or construction drawings without the certification of a professional engineer registered in the state in which the wall will be constructed. These drawings are "typical" and may be amended or revised by the SRW engineer based on project site conditions and purposes.

| No. | Date. | Revision. | By. |
|-----|-------|-----------|-----|
| | | | |
| | | | |
| | | | |

PREPARED BY:

| Legend | |
|--------|---------------|
| | Leveling Pad |
| | Drainage Rock |
| | Geogrid |
| | Finish Grade |
| | Filter Fabric |

Project Name: _____
 Project Location: _____
 Drawing Description: **Typical Details**
 Prepared For: _____
 Drawn By: _____ Checked By: _____
 Sheet: _____
 Date: _____
 Project Number: _____